

Metal Building Crematory Design

from *Cremation Systems*

Human and/or Pet Cremation Facilities

Installation by our factory-trained technicians



CFS-2300 Human and Pet Cremation Chambers



Arrive **Tuesday** morning with retort and crane, retort installed, stack erected, decorative cover installed.

Wednesday — Connect the utilities, run the chamber, teach operation and maintenance procedures.

Thursday — Perform the first cremations. If no case is available, we provide guidance via our internet based Tek Marshal.

If you have a building or are considering a structure, give us a call and we can establish if it is suitable for a crematory and if it is properly zoned.



For many cremation locations in America, a prefabricated metal building is the most economical type of structure available. Typically, a metal building can be built with office and bathroom facilities for \$50/ft². Generally a 30' x 40' crematory office floor plan can accommodate a Human and Pet retort or two Human chambers. Site conditions and utility access can be variable, but a 1,200 ft² crematory typically will cost \$60,000. Cremation Systems normally delivers a Human retort and accessories, installs the equipment, fires the chamber, and trains your cremationists, for approximately \$135,000. Total cost for a suitable metal building* and cremation equipment in most U.S.A. markets is normally less than \$200,000.

| | |
|---------------------------------------|----------------------|
| Metal components delivered — | \$20/ft ² |
| Metal building construction — | \$10/ft ² |
| Concrete slab — | \$10/ft ² |
| Interior walls, bathroom, utilities — | \$10/ft ² |

\$60K building, **\$135K** Human retort, delivery, installation, and accessories.

All for less than \$200K

* Metal building supplied and installed by others.



Cremation Systems™

Division of Armil CFS, Inc.

15660 South LaSalle Street
South Holland, IL 60473

708-339-6810

Fax: 708-339-0517

www.cremsys.com



© 2019, Cremation Systems

Metal Building Crematory Design from *Cremation Systems*

Key Features include:

- ◆ Remote problem diagnosis via the Internet
- ◆ State Air Operating Permit submission
- ◆ Electric hydraulic lift table with digital scale
- ◆ Processing station
- ◆ Decorated stack
- ◆ Viewing window
- ◆ Quick Change Hearth System
- ◆ Fire Marshal crematory monitoring system
- ◆ Floor plans are fully reversible

Exclusive safety and monitoring systems

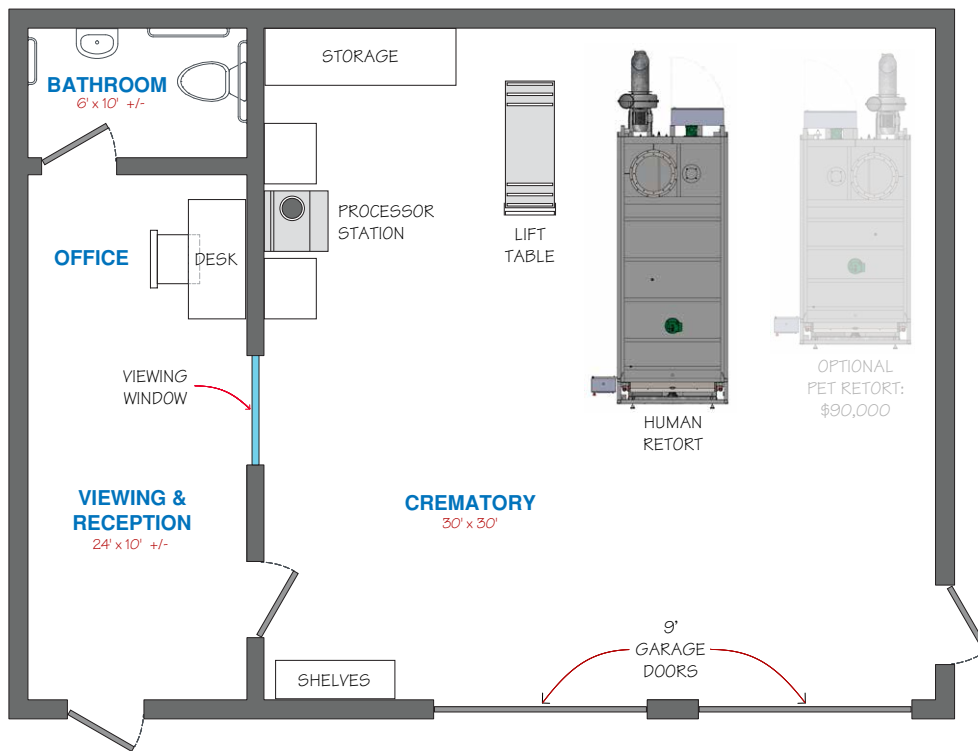
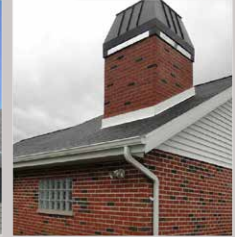

Lift Table

Electric, hydraulic, digital scale



Processor Station

Typical Floor Plan

1200 ft² — Office, Bathroom, Viewing/Reception, Accessories with Human Retort: ≤ \$200,000
 or Human and Pet Retorts: ≤ \$290,000

For more information about our cremation equipment, send us a request on our Contact Us page, or contact:

Tom Krowl

Vice President of Marketing
 Cremation Systems

708-339-6810 • tom@cremsys.com